

FUNCTION DESCRIPTION

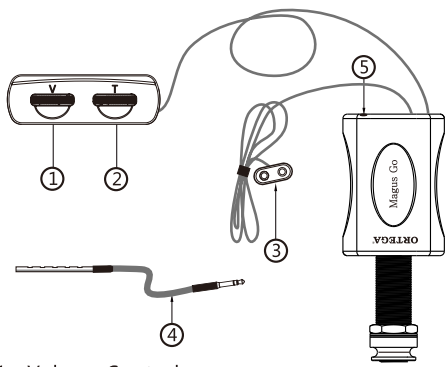

- 1、 Volume Control
- 2、 Tone Control
- 3、 Connect Of Battery
- 4、 Pickup
- 5、 2.5mm input of pickup

- *Convenient Output Jack Style Pickup (easy to install, no need to cut the hole in the side of guitar)*
- *Classic piezo pickup*
- *Setup with volume and tone control*
- *Base output: high-end output with 6.5mm high impedance*
- *Power supply:9V*

ORTEGA®

Magus Go

Output Jack Pickup Style Manual

INSTALLATION

Step 1: Make a hole at the tail of the guitar with 12mm drill, then fit the output jack in.

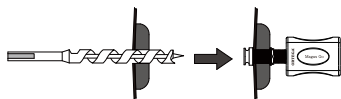

Step 2: Drill 3mm hole for pickup wire at either end of slot.

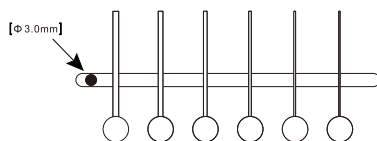

Step 3: Insert pickup into slot so that when laid flat, the opposite end of pickup lies against slot edge.

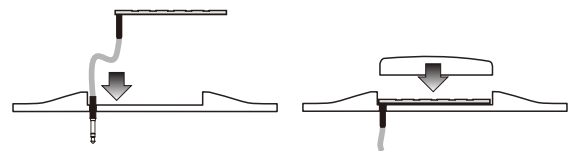

Step 4: Place the battery bag with 9V battery in, tie up the spare cable then stick at the back inside of the guitar

